

2 Way Diverter Valves Series "D"



Straight Configuration - ST



Wye Configuration - Y

Available in sizes from 2" up to 12"

Pneumatic actuated 2 Way Diverter Valve for vacuum or low pressure* conveying systems

Inlets & Outlets available in Tube & Pipe sizes in Stainless Steel, Aluminum & Carbon Steel

*(Dilute phase up to 15 psig max.)

Standard Features

- Positive Blade Lock (PBL) between blade & cylinder rod
- Internal magnetic piston, cushioned air cylinder
- Polished stainless steel blade • Active Compression Seals (ACS)
- Light weight aluminum body construction • Temperature rated for up to 82° C (180° F)
- Wall thickness of 16, 14, & 11 gauge, schedule 10, 40 & 80
- Fully tested prior to shipping

2 Way Diverter Valves - Series "D"

Straight Configuration - "ST"

Model number	Size A	B	C	E	F	G	H
DV2-200	2	9½	4	5	7	14½	2½
DV2-2375	2 ^{3/8}	10	5	6	9½	17 ^{3/8}	3½
DV2-250	2½	11½	4	6	9½	17 ^{3/8}	3½
DV2-2875	2 ^{7/8}	11½	5	6	9½	17 ^{3/8}	3½
DV2-300	3	11½	4	6	9¼	17 ^{3/8}	3½
DV2-350	3½	17½	4	7	13	21	5
DV2-400	4	15½	4	7	13	21	5
DV2-450	4½	19	5	9	15¼	23½	6
DV2-500	5	17½	5	9	15¼	23½	6
DV2-5563	5 ^{9/16}	22	7	10	18¼	27 ^{3/8}	7
DV2-600	6	20	5	10	18¼	27 ^{3/8}	7
DV2-6625	6 ^{5/8}	20	7	11	26½	35¼	10
DV2-800	8	23	9	12	26½	37½	10
DV2-1000	10	29	9½	15¼	35	54½	12
DV2-1200	12	35	10	16	44	75	14

Dry, filtered & lubricated actuating air @ 80 psig min., 200 psig max. recommended

DV2-ST - Top View

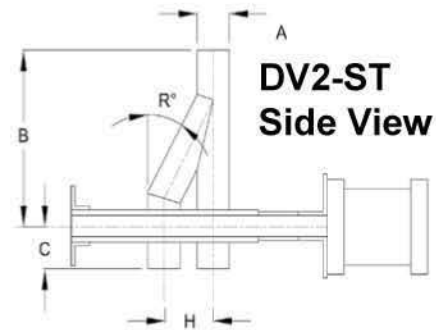
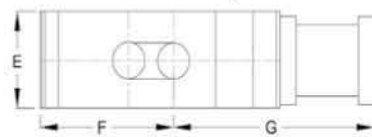

Options

- Position switches 5 volt to 240 volt AC/DC
- Proximity switches
- Over sized cylinders
- Valve body sealed for air purging
- Inlets/outlets - straight or flanged ends
- High temperature modifications
- Manual hand wheel operation
- Special seal configurations
- Solenoids 110 volt AC or 24 volt DC
- NEMA 7-9 hazardous locations
Class I, Groups B, C&D, Class II, Groups E, F&G
- Double acting or single acting spring return solenoid or manual lever valve

Wye Configuration - "Y"

Model number	Size A	B	C	E	F	G	H	R
DV2-150	1 1/2	7 1/4	4 1/8	5	5 3/4	14 3/4	2 1/2	30
DV2-200	2	7 1/4	4 1/8	5	5 3/4	14 3/4	2 1/2	30
DV2-2188	2 3/16	8	4	6	7 3/4	18 3/8	3 1/2	30
DV2-2375	2 3/8	10 1/8	5 1/8	6	7 3/4	18 3/8	3 1/2	30
DV2-250	2 1/2	8	4 1/8	6	7 3/4	18 3/8	3 1/2	30
DV2-2875	2 7/8	10	5	6	7 3/4	18 3/8	3 1/2	30
DV2-300	3	8 5/8	4 1/8	6	7 3/4	18 3/8	3 1/2	30
DV2-350	3 1/2	12 3/4	6 1/8	7	10 1/2	22 3/4	5	30
DV2-400	4	10 3/8	4 1/8	7	10 1/2	22 3/4	5	30
DV2-450	4 1/2	13 3/4	6 1/8	9	12 3/4	25 3/4	6	30
DV2-500	5	12 5/8	5 1/8	9	12 3/4	25 3/4	6	30
DV2-5563	5 9/16	15 1/4	6 1/8	10	14 3/4	30 1/8	7	30
DV2-600	6	13 7/8	5 1/8	10	14 3/4	30 1/8	7	30
DV2-6625	6 5/8	15 1/2	7	11	21 3/8	38	10	45
DV2-800	8	19 1/8	9 1/8	12	21 1/2	38 1/2	10	45
DV2-8625	8 5/8	19 3/4	8 1/4	14	24 1/2	44 1/4	12	45
DV2-1000	10	21 3/4	9 5/8	15 3/4	28 1/4	49 1/2	14	45
DV2-1075	10 3/4	22 3/4	9 3/4	15 3/4	28 1/4	49 1/2	14	45
DV2-1200	12	24 1/4	9 3/4	16	29	49 1/2	14	45

Dry, filtered & lubricated actuating air @ 80 psig min., 200 psig max. recommended

DV2-Y - Top View

